

# Alpine A-Frame Cabin

## WITH 6' OVERHANG

### STANDARD FEATURES

**FLOOR MODELS** see page 7  
see price list for flooring options

**SIDEWALL HEIGHT**  
8' sidewalls

**ROOF**  
12 Pitch roof  
Aluminum dripedge  
6' overhang  
30 year dimensional shingles

**CONSTRUCTION**  
Strongback Nailer  
Primed Smartside Siding  
2x4" wall framing  
2x4" double top-plate  
Air Vents  
Wall studs 16" o.c.  
6' treated deck with posts and "Y" braces  
6" fascia trim  
Synthetic Felt Paper  
Hurricane anchors

### LOFTS

Full loft w/steps landing and railing  
Loft below top plate  
2x10" loft joists 16" o.c. 16' wide buildings  
14" floor trusses 24" o.c. 20' wide buildings  
16" floor trusses 24" o.c. 24' wide buildings

### DOORS

Entrance door with glass

### POPULAR OPTIONS

Vinyl insulated windows  
Ridgevent and vented soffit  
Additional doors  
Loft-view opening

### BUILDING SIZES

WIDTH	DEPTH						HEIGHT
	20'	24'	28'	32'	36'	40'	
16'	•	•	•	•	•	•	17' 7"
20'	•	•	•	•	•	•	19' 9"
24'	•	•	•	•	•	•	21' 9"

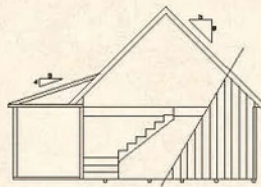

20x28' A-frame cabin with options



full loft, standard feature  
(interior finish/work by customer)



16x20' A-Frame cabin with vinyl siding

