

Garages



24x28' Garage
options shown:
2-9x7' garage doors
45° garage door corners
6 pitch roof
cupola & weathervane
gutters

STANDARD FEATURES

Floor Model

Permanent foundation required
– see page 43.

Sidewall Height

8' sidewalls

Roof

4 pitch roof
Aluminum dripedge
30 year dimensional shingles
OSB roof sheathing
12" overhang on all sides

Construction

Strongback Nailers
Primed Smartside Siding
2x4" wall framing
2x4" double top-plate
Wall studs 16" o.c.
Air vents
Synthetic felt paper
Truss Anchor Screws

Doors

Entrance door with glass

POPULAR OPTIONS

Vinyl insulated windows
Ridgevent and vented soffit
8-16' wide garage doors
Vinyl siding
Steeper roof pitch
2x6" walls

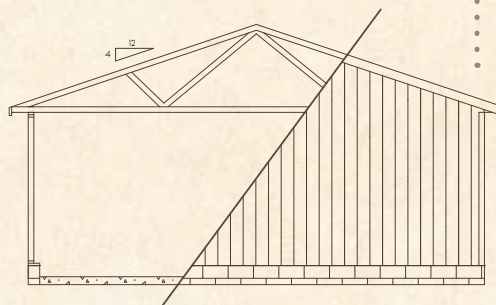

BUILDING SIZES

| WIDTH | DEPTH | | | | | | HEIGHT |
|-------|-------|-----|-----|-----|-----|-----|---------|
| | 20' | 24' | 28' | 32' | 36' | 40' | |
| 20' | • | • | • | • | • | • | 12' |
| 24' | | • | • | • | • | • | 12' 10" |

GARAGE DOOR COLORS



Due to variables in the printing process, color samples may vary in color and sheen from the actual materials.